

4th-Annual  
**SPE TPO**  
Shanghai

Thermoplastic Engineered  
Polyolefins Conference

April 3-5, 2019 | Shanghai Marriott Hotel City Centre  
The New Era of Automotive TPO's

Sponsored by



AUTOMOTIVE

# 2019 TPO Shanghai Conference

April 3-5 2019

Shanghai Marriott City Center

Facility, Exhibit & Technical Session Layout

4th Annual  
**SPE TP**  
Shanghai

Thermoplastic Engineered  
Polyolefins Conference

April 3-5, 2019 | Shanghai Marriott Hotel City Centre  
The New Era of Automotive TPO's

Sponsored by



AUTOMOTIVE

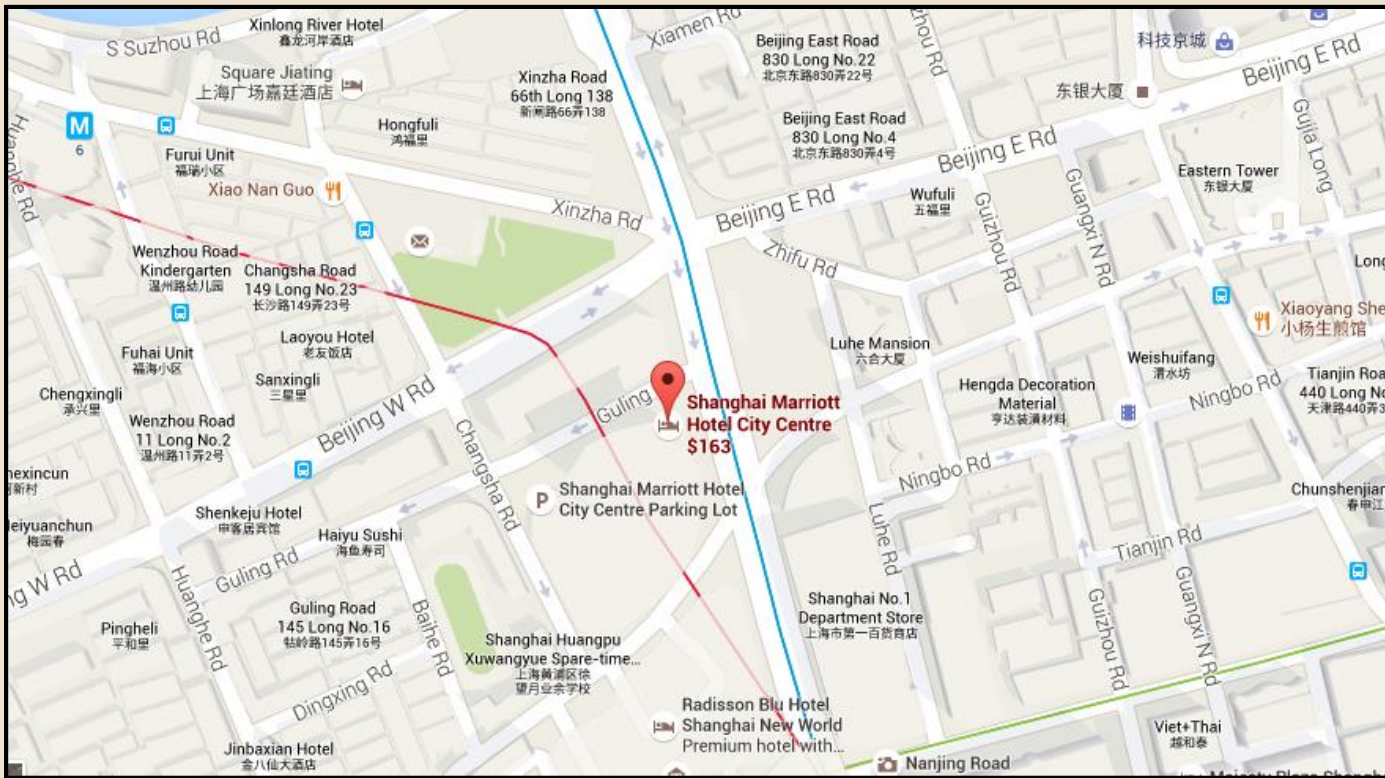

**SHANGHAI MARRIOTT HOTEL CITY CENTRE**

555 Xi Zang Road (Middle), Huangpu District  
Shanghai, 200003 China

T: +86 21 2312 9888 F: +86 21 2312 9999

[www.shanghaimarriott.com](http://www.shanghaimarriott.com)

4th-Annual  
**SPE TPO**  
Shanghai

Thermoplastic Engineered  
Polyolefins Conference

April 3-5, 2019 | Shanghai Marriott Hotel City Centre  
The New Era of Automotive TPO's

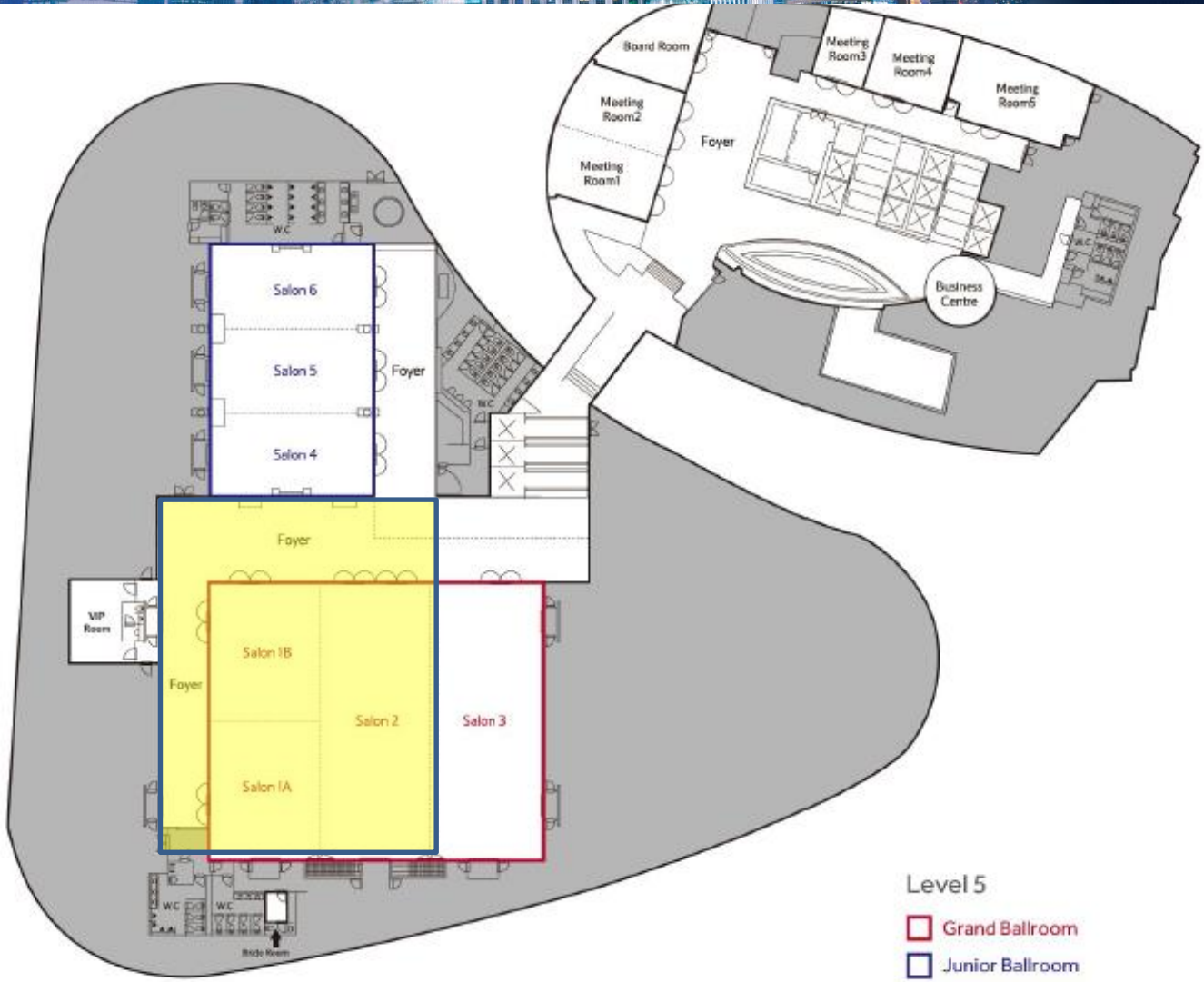

Level 5

- Grand Ballroom
- Junior Ballroom

4th-Annual

# SPE TPO Shanghai

Thermoplastic Engineered Polyolefins Conference

April 3-5, 2019 | Shanghai Marriott Hotel City Centre

## The New Era of Automotive TPO's

Sponsored by



AUTOMOTIVE

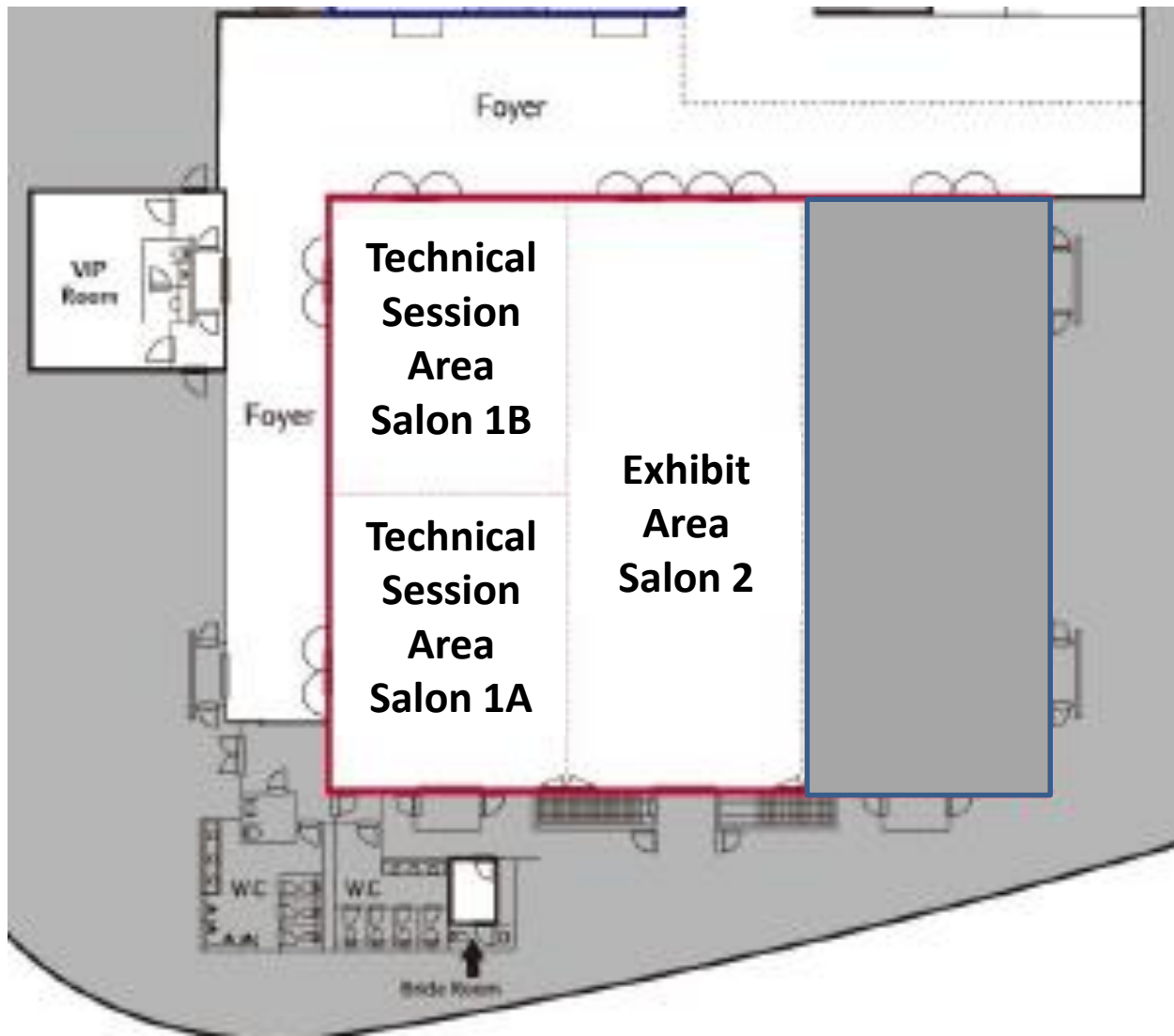

4th-Annual  
**SPE TPO**  
Shanghai

Thermoplastic Engineered  
Polyolefins Conference

April 3-5, 2019 | Shanghai Marriott Hotel City Centre  
The New Era of Automotive TPO's



Tall Round  
Tables (4)

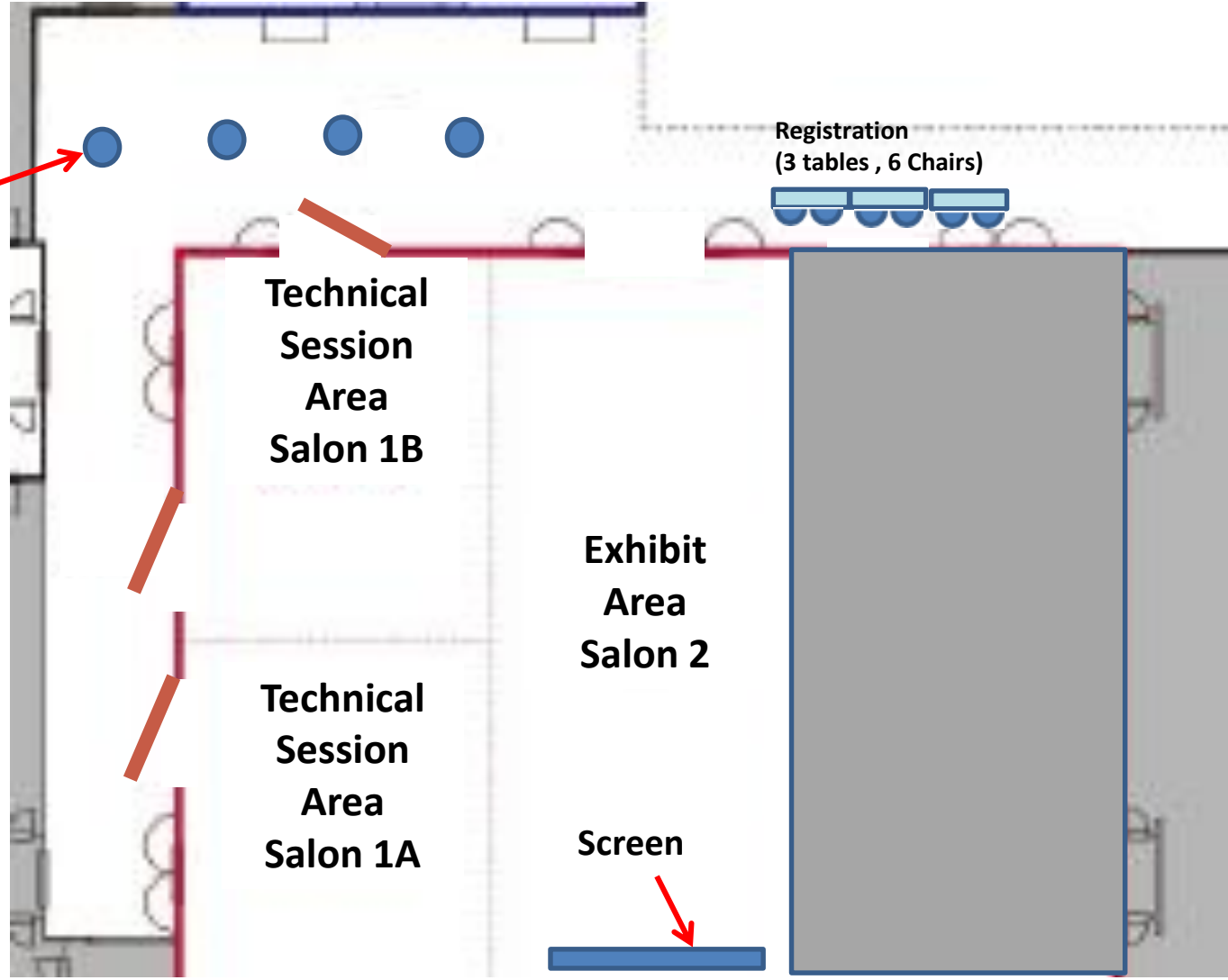

**Facilit**  
Level 5 - G

4th Annual  
**SPE TPO**  
 Shanghai

Thermoplastic Engineered  
 Polyolefins Conference

April 3-5, 2019 | Shanghai Marriott Hotel City Centre  
 The New Era of Automotive TPO's



April 3-4 2019  
 Morning Set-up

**Technical Sessions Morning**  
 (220 theater seating  
 Salon 1A & 1B  
 Combined)

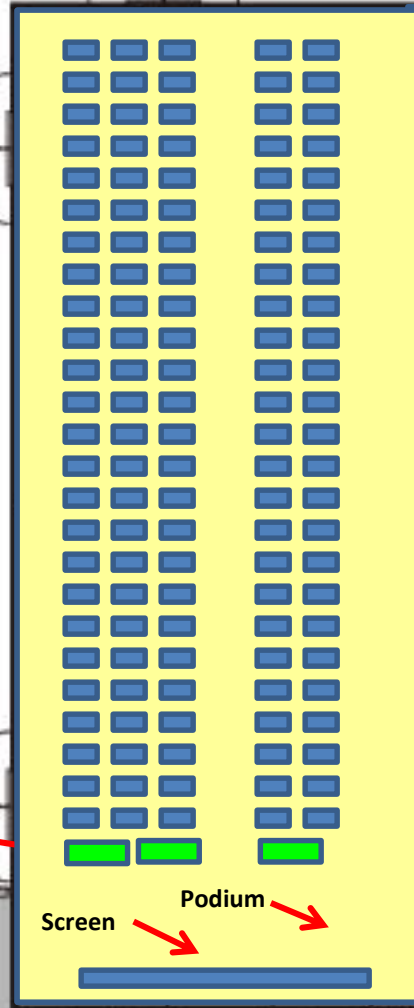

- |                                    |                                |
|------------------------------------|--------------------------------|
| Advanced Composite<br><b>1</b>     | Formosa Group<br><b>8</b>      |
| Alterra Holdings<br><b>2</b>       | Borealis Group<br><b>9</b>     |
| Cimbar Perf. Materials<br><b>3</b> | Inteva Products<br><b>10</b>   |
| Dow Chemical Pacific<br><b>4</b>   | Reliable Analysis<br><b>11</b> |
| Branson Ultrasonic<br><b>5</b>     | Autodesk<br><b>12</b>          |
| Moldex3D<br><b>6</b>               | LyondellBasell<br><b>13</b>    |
| e-xStream Engineering<br><b>7</b>  | Kraton China<br><b>14</b>      |
|                                    | ExxonMobil<br><b>15</b>        |

Coffee Soda | Food

**Exhibitor Area**

32 spaces  
 (10' L x 8' w x 15' H)

20 - 6' Tables with Table cover and two chairs as shown

11 Tall Round Tables

Food, Coffee & Soda Table



4th-Annual  
**SPE TPO**  
 Shanghai

Thermoplastic Engineered  
 Polyolefins Conference

April 3-5, 2019 | Shanghai Marriott Hotel City Centre  
 The New Era of Automotive TPO's



April 3-4 2019  
 Afternoon Set-up

Technical  
 Sessions  
 Afternoon  
 (100 theater  
 seating  
 Salon 1A &  
 100 Theater  
 Seating Salon 1B  
 except 1<sup>st</sup> row)

Tables 1<sup>st</sup> Row

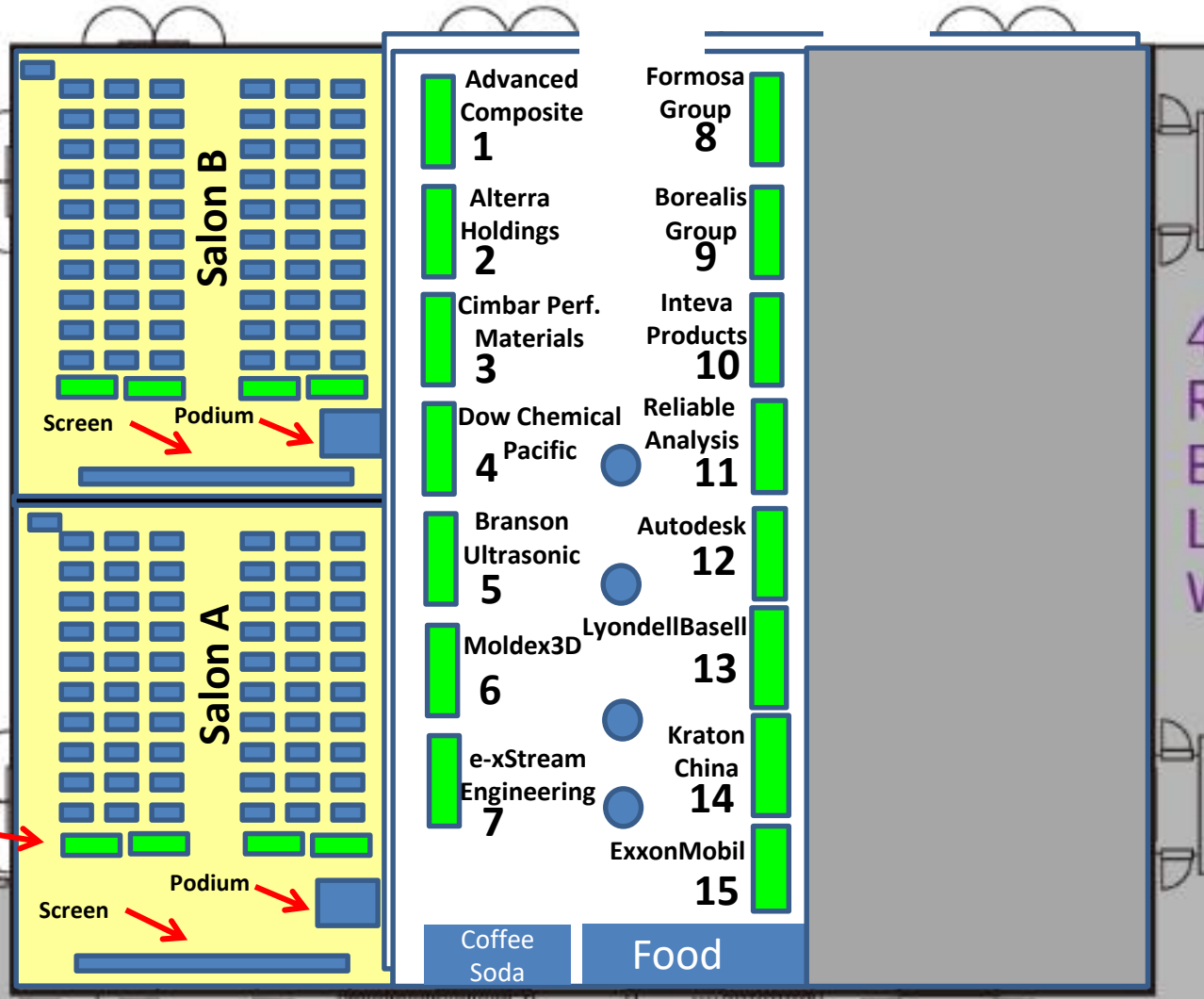

**Exhibitor  
 Area**

32 spaces  
 (10' L x 8' w x 15' H)

20 - 6' Tables  
 with Table  
 cover and two  
 chairs as  
 shown

11 Tall Round  
 Tables

Food, Coffee  
 & Soda Table

- |                                    |                                |
|------------------------------------|--------------------------------|
| Advanced Composite<br><b>1</b>     | Formosa Group<br><b>8</b>      |
| Alterra Holdings<br><b>2</b>       | Borealis Group<br><b>9</b>     |
| Cimbar Perf. Materials<br><b>3</b> | Inteva Products<br><b>10</b>   |
| Dow Chemical Pacific<br><b>4</b>   | Reliable Analysis<br><b>11</b> |
| Branson Ultrasonic<br><b>5</b>     | Autodesk<br><b>12</b>          |
| Moldex3D<br><b>6</b>               | LyondellBasell<br><b>13</b>    |
| e-xStream Engineering<br><b>7</b>  | Kraton China<br><b>14</b>      |
|                                    | ExxonMobil<br><b>15</b>        |

Coffee Soda | Food



**Friday  
 April 5, 2019  
 Morning  
 No Technical  
 Session  
 Only  
 Exhibitor  
 Review**

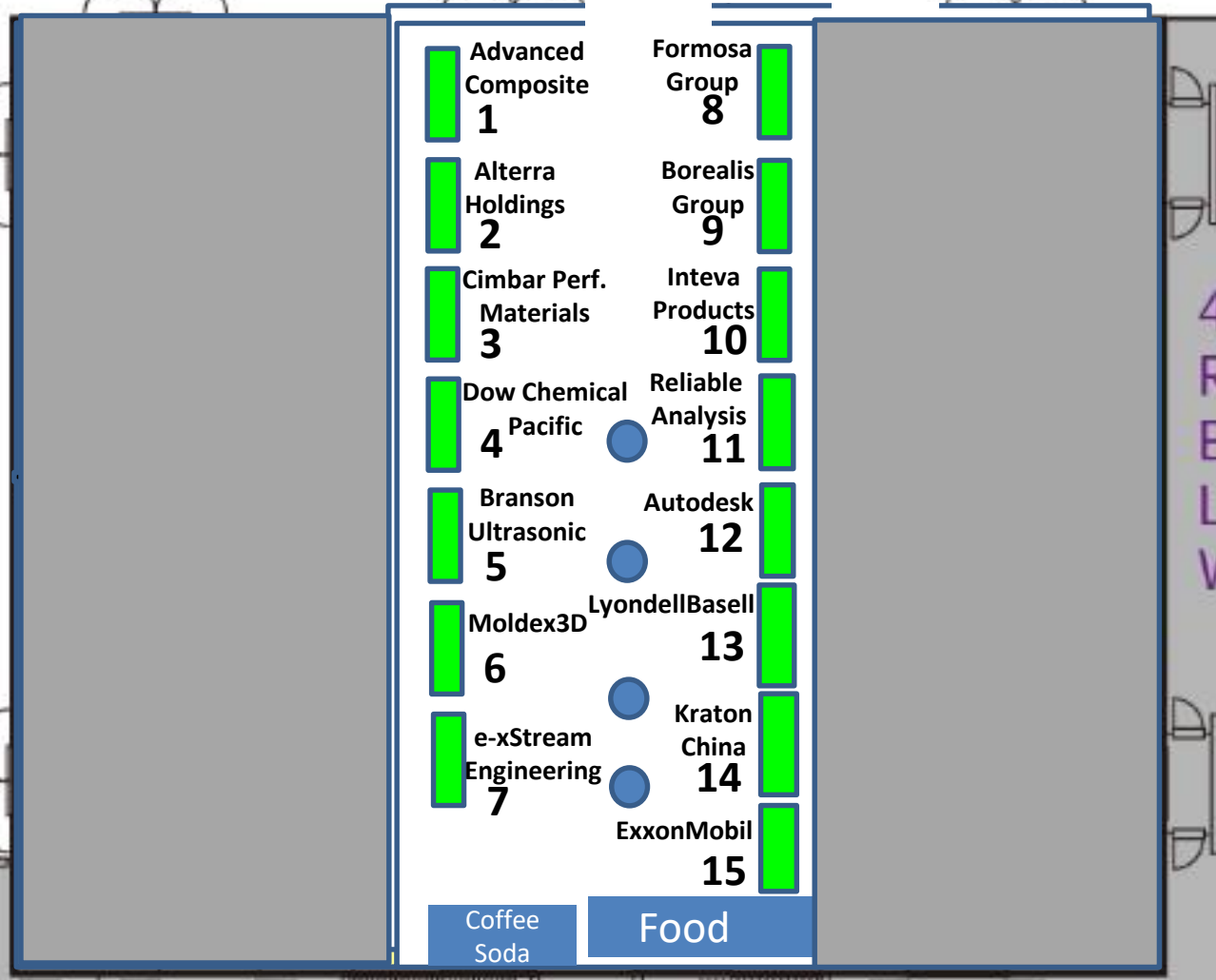

## Exhibitor Area

**32 spaces**  
 (10' L x 8' w x 15' H)

20 - 6' Tables with Table cover and two chairs as shown

11 Tall Round Tables

Food, Coffee & Soda Table